



INTAKE SYSTEM

INSTALLATION INSTRUCTIONS

21-844C

FORD

2018-21 Mustang GT

V8-5.0L

NOT LEGAL FOR SALE OR USE ON ANY POLLUTION CONTROLLED MOTOR VEHICLE IN CALIFORNIA OR STATES ADOPTING CALIFORNIA EMISSION PROCEDURES.

See aemintakes.com for CARB status on each part for a specific vehicle

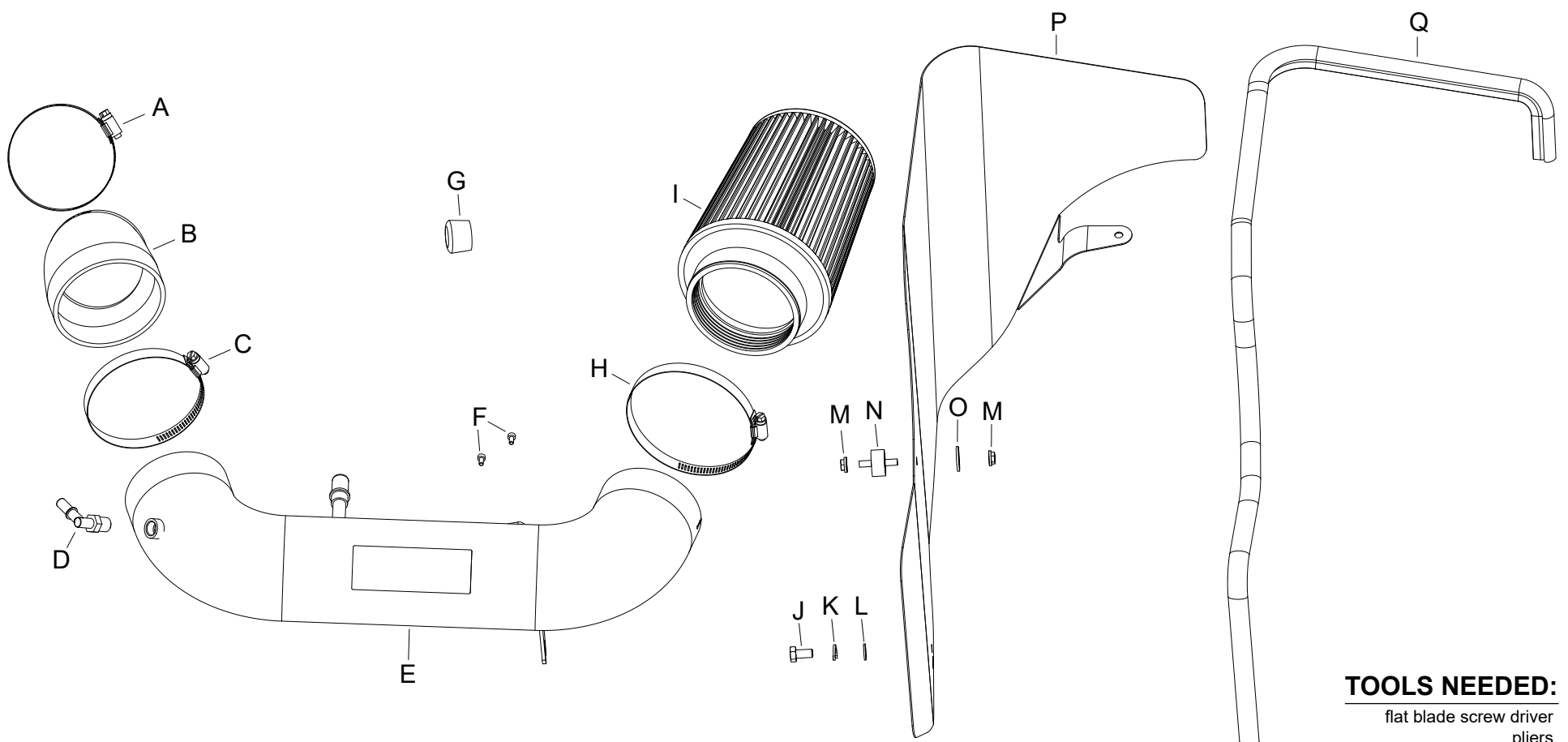

TOOLS NEEDED:

flat blade screw driver
pliers
ratchet
extension
15mm socket

PARTS LIST:

Description	Qty.	Part #	Description	Qty.	Part #	Description	Qty.	Part #
A HOSE CLAMP; #56	1	08620	G CAPLUG; 15/16" ID, 3/4" L, BLK	1	08246	M NUT; SERRATED M6	2	KIT20WFCZ060
B COUPLER; 3.5"ID X 4"ID	1	5-1100	H 1/2" BNDHOSE CLAMP, 3.56"	1	9464	N STUD; M6-1.00 M/M, RUBBER	1	07027
C HOSE CLAMP; #64 STAINLESS	1	08645	I AIR FILTER; 4" X 7" DRYFLOW	1	21-2057DK	O WASHER; 1"D X 1/4 HOLE	1	08160
D VENT; 90*, 1/4NPT TO .375"	1	82632	J BOLT; 8MM-1.25 X 16MM	1	07844	P HEAT SHIELD	1	20-8623
E INTAKE TUBE	1	2-1614C	K WASHER, M8 SPLIT LOCK ZINC	1	1-3036	Q EDGE TRIM; 66"L	1	102472
F BOLT; M4 - .7 X 8MM, A/H CAP	2	07733	L WASHER; 8MM, FLAT	1	08272			

If you need any assistance please call 1-800-858-3333 to speak with a representative in our Customer Service Center before returning the product.

Read and understand these instructions **BEFORE** attempting to install this product. Failure to follow installation instructions and not using the provided hardware may damage the intake tube, throttle body and engine.

TO START:

1. Turn off the ignition and disconnect the negative battery cable.

NOTE: Disconnecting the negative battery cable erases pre-programmed electronic memories. Write down all memory settings before disconnecting the negative battery cable. Some radios will require an anti-theft code to be entered after the battery is reconnected. The anti-theft code is typically supplied with your owner's manual. In the event your vehicles anti-theft code cannot be recovered, contact an authorized dealership to obtain your vehicles anti-theft code.



2. Remove the four nuts that secure the strut brace and then remove the strut brace from the vehicle.



3. Pop up the two-round bolt covers and then remove the two nuts that secure the decorative engine cover and remove the cover from the engine.



4. Release the spring clamp that secures the sound tube to the intake tube fitting and then disconnect the sound tube from the intake tube.



5. Release the one-time use clamp that secures the sound tube to the drum and then disconnect and remove the sound tube from the vehicle.



6. Disconnect the vent lines attached to the intake tube. Loosen the hose clamps that secure the intake tube to the air filter housing and throttle body and then remove the intake tube from the vehicle.



7. Install the provided caplug onto the sound drum.



8. Disconnect the mass air sensor electrical connection.



9. Remove the bolt that secures the air filter housing to the inner fender. Lift the air filter housing up to dislodge it from the mounting grommet and then remove the complete system from the vehicle.
NOTE: AEM recommends that customers do not discard factory air intake.

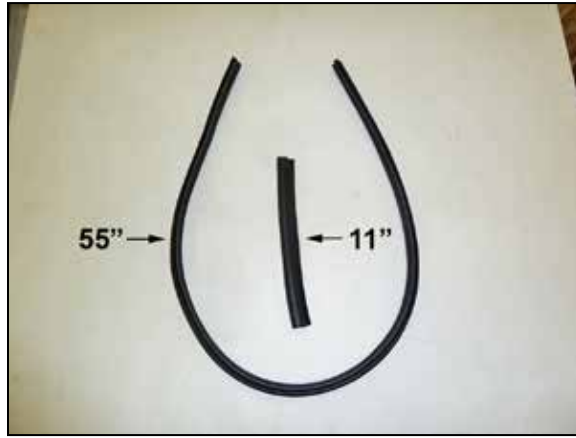

10. Cut the provided edge trim into two sections, one section will be 11" long and one section will be 55" long.



11. Install the edge trim onto the heat shield as shown. Install the rubber mounted stud into the top hole of the heat shield.



12. Install the heat shield assembly into the vehicle and secure to the factory air filter housing mounting location and to the frame rail using the provided hardware.



13. Install the provided coupler (5-1100) onto the throttle body and secure with the provided hose clamp.



14. Remove the mass air sensor from the factory air filter housing and install it into the AEM® intake tube using the provided hardware. Install the 90° NPT fitting as shown.



15. Install the AEM® intake tube into the coupler at the throttle body and onto the rubber mounted stud in the heat shield. Adjust the tube for best fit and then secure with the provided hardware and hose clamp. Connect the crankcase vent and EVAP vent lines.



16. Connect the mass air sensor electrical connection.



17. Install the AEM® air filter onto the intake tube and secure with the provided hose clamp.



18. Reinstall the decorative engine cover and strut bar, secure with the factory hardware.



Reassemble Vehicle

Position the inlet pipes for the best fitment. Be sure that the pipes or any other components do not contact any part of the vehicle. Tighten the rubber mount, all bolts, and hose clamps. Check for proper hood clearance. Re-adjust pipes if necessary and re-tighten them. Inspect the engine bay for any loose tools and check that all fasteners that were moved or removed are properly tightened. Reconnect negative battery terminal and start engine. Let the vehicle idle for 3 minutes. Perform a final inspection before driving the vehicle.

Service and Maintenance

AEM Induction Systems requires cleaning the intake system's air filter element every 100,000 miles. When used in dusty or off-road environments, our filters will require cleaning more often. We recommend that you visually inspect your filter once every 25,000 miles to determine if the screen is still visible. When the screen is no longer visible some place on the filter element, it is time to clean it. To clean, purchase our Synthetic air filter cleaner, part number 1-1000 and follow the easy instructions. Use window cleaner to clean your powder coated AEM® intake tube.

NOTE: DO NOT USE aluminum polish on powder coated AEM® intake tubes.

NOT LEGAL FOR SALE OR USE ON ANY POLLUTION CONTROLLED MOTOR VEHICLE IN CALIFORNIA OR STATES ADOPTING CALIFORNIA EMISSION PROCEDURES.

See aemintakes.com for CARB status on each part for a specific vehicle

AEM Air Intake System Warranty Policy

AEM® warrants that its intake systems will last for the life of your vehicle. AEM will not honor this warranty due to mechanical damage (i.e. improper installation or fitment), damage from misuse, accidents or flying debris. AEM will not warrant its powder coating if the finish has been cleaned with a hydrocarbon-based solvent. The powder coating should only be cleaned with a mild soap and water solution. Proof of purchase of both the vehicle and AEM intake system is required for redemption of a warranty claim.

This warranty is limited to the repair or replacement of the AEM part. In no event shall this warranty exceed the original purchase price of the AEM part nor shall AEM be responsible for special, incidental or consequential damages or cost incurred due to the failure of this product. Warranty claims to AEM must be transportation prepaid and accompanied with dated proof of purchase. This warranty applies only to the original purchaser of product and is nontransferable. Improper use or installation, use for racing, accident, abuse, unauthorized repairs or alterations voids this warranty. AEM disclaims any liability for consequential damages due to breach of any written or implied warranty on all products manufactured by AEM. Warranty returns will only be accepted by AEM when accompanied by a valid Return Merchandise Authorization (RMA) number. Credit for defective products will be issued pending inspection. Product must be received by AEM within 30 days of the date RMA is issued.

If you have a warranty issue, please call (800) 992-3000 and our customer service department will assist you. A proof of purchase is required for all AEM warranty claims.