



INTAKE SYSTEMS FOR VEHICLES LISTED ARE 50 STATE LEGAL. SEE KNFILTERS.COM FOR CARB STATUS ON EACH PART FOR A SPECIFIC VEHICLE.

INSTALLATION INSTRUCTIONS

57-1140
CAN-AM
2015-17 Maverick 1000R
976cc Turbo

TOOLS NEEDED:

- ratchet
- extension
- 10mm socket
- 7mm socket
- t27 torx
- t30 torx
- pliers
- flat blade screw driver

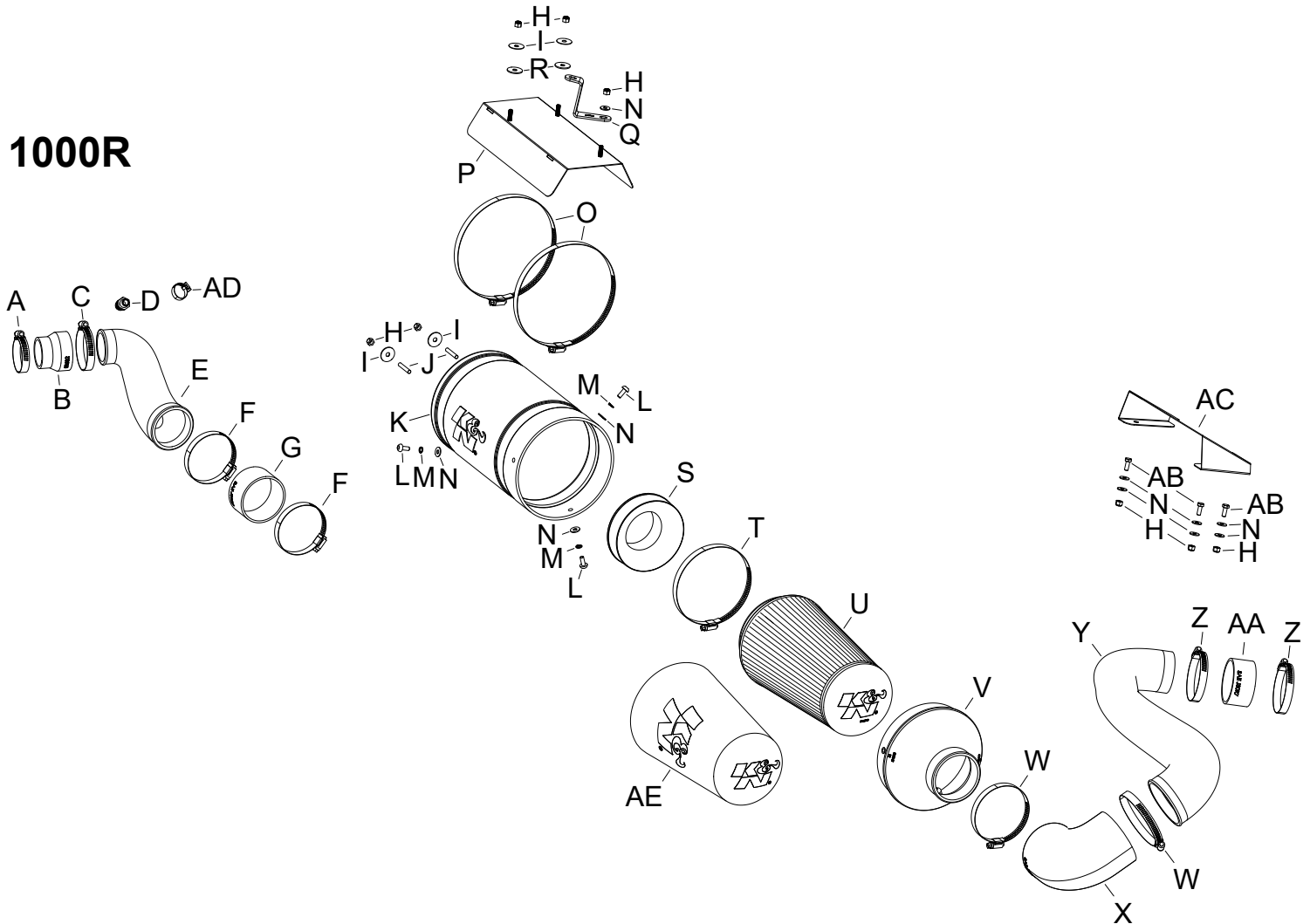

PARTS LIST:

Description	Qty.	Part #	Description	Qty.	Part #	Description	Qty.	Part #
A HOSE CLAMP; #28	1	08483	K CANNISTER; (LQ)	1	087344A	U FILTER CHARGER	1	RU-5065XD
B HOSE; 1.75"ID TO 2.25"ID	1	08682	L BOLT; M6 X 1 X 16MM	3	07730	V LID; (LR)	1	087345A
C HOSE CLAMP; #36	1	08530	M WASHER, M6 SPLIT LOCK ZINC	3	1-3025	W HOSE CLAMP; #56	2	08620
D VENT; STRT, 5/8 BARBED 1/4	1	08911-2	N WASHER; 6MM FLAT	10	08269	X HOSE; 3.5"ID 90DEG ANGLED	1	08502
E TUBE; (LT)	1	087347A	O HOSE CLAMP; #116	2	08647	Y FRESH AIR TUBE; (LS)	1	087346A
F HOSE CLAMP; #48	2	08601	P BRACKET; TRAY	1	073243	Z HOSE CLAMP; #44	2	08577
G HOSE; 3"ID X 1.75"L	1	08190	Q BRACKET; "Z"	1	083110	AA HOSE; 2.75"ID X 1.5"L	1	08179
H NUT; 6MM NYLOCK	8	07512	R WASHER; 1" X .300 X .100	2	21685	AB BOLT; M6-1 X 16MM	3	07812
I WASHER; 1"D X 1/4 HOLE	4	08160	S ADAPTER; FILTER, 3"OD	1	21569	AC AIR SCOOP	1	073244
J STUD; M6-1 X 30 DBL	2	1-107	T HOSE CLAMP; #80	1	08694	AD HOSE CLAMP; #10 MINI	1	08411
						AE EXTREME DUTY PRECLEANER	1	25-5168

If you need any assistance please call 1-800-858-3333 to speak with a representative in our Customer Service Center before returning the product.

NOTE: FAILURE TO FOLLOW INSTALLATION INSTRUCTIONS AND NOT USING THE PROVIDED HARDWARE MAY DAMAGE THE INTAKE TUBE, THROTTLE BODY AND ENGINE.

TO START:

1. Turn off the ignition and disconnect the negative battery cable.
NOTE: Disconnecting the negative battery cable erases pre-programmed electronic memories. Write down all memory settings before disconnecting the negative battery cable. Some radios will require an anti-theft code to be entered after the battery is reconnected. The anti-theft code is typically supplied with your owner's manual. In the event your vehicles anti-theft code cannot be recovered, contact an authorized dealership to obtain your vehicles anti-theft code.



2. Remove the two bolts and nuts shown that secure the cargo tray to the frame.
NOTE: The nuts are on the underside and will need to be held with a wrench while loosening the bolts.

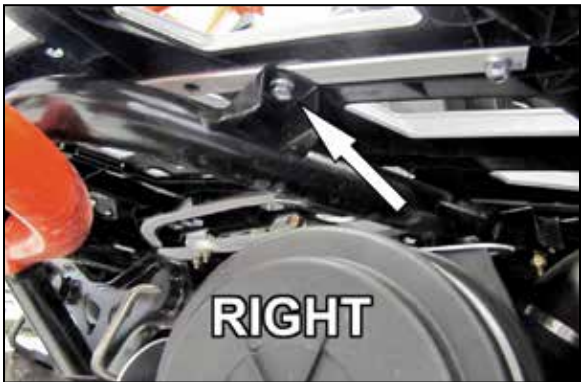

3. Remove the bolts that secure the package tray from the underside.
NOTE: there is one on the left and right side.



4. Lift off the package tray and set aside.



5. Remove the four bolts that secure the right side charger air cooler cover and then remove the cover.
NOTE: the front bolt has limited access due to the proximity of the seat, use care while removing the bolt so as not to damage the seat.



6. Remove the three push clips and then remove the fresh air dust cover.



7. Cut the pinch clamp securing the waste gate valve vacuum hose and then disconnect the vacuum hose from the vacuum switch.



8. Loosen the hose clamp that secures the intake hose to the turbo inlet and then disconnect the hose from the turbo.



9. Loosen the hose clamp that secures the fresh air intake hose to the mount and then disconnect the fresh air hose.



10. Remove the three bolts that secure the air filter assembly.
NOTE: Two bolts secure the top and one bolt secures from the bottom.



11. Partially remove the air filter assembly to gain access to the crank case vent hose connection to the intake tube. Cut the pinch clamp securing the crank case vent hose and then disconnect the hose from the intake tube and then completely remove the air filter system.

NOTE: K&N Engineering, Inc., recommends that customers do not discard factory air intake.



12. Remove the two bolts that secure the fresh air tube mount to the body and remove the mount.
NOTE: The bolts are accessed from the underside. These bolts will be reused in the next step.



13. Install the fresh air scoop onto the tube mount using the provided hardware, then reinstall the assembly to the body using the factory bolts from the previous step.

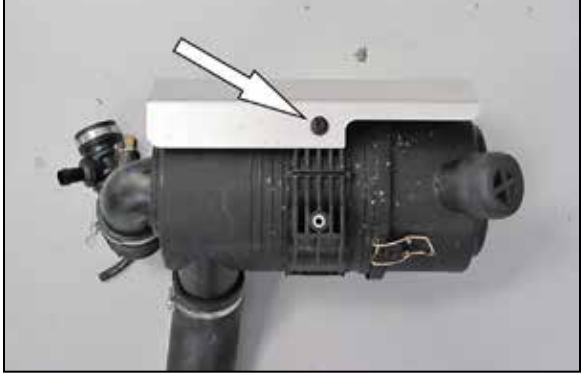

14. Remove the bolt that secures the heat shield to the air filter assembly and remove the heat shield.

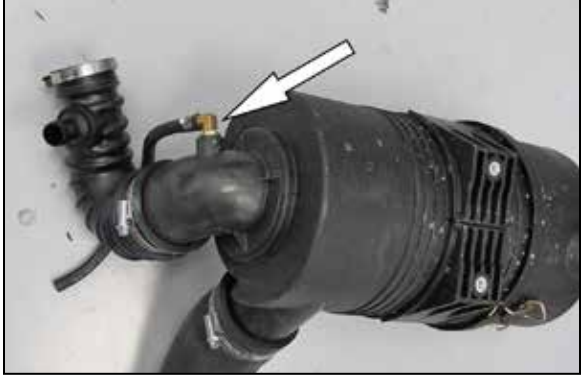

15. Remove the waste gate hose and fitting from the factory intake tube.



16. Install the waste gate hose and fitting along with the provided crank case vent hose fitting into the K&N® intake tube as shown.

NOTE: NPT fitting has tapered threads and only designed to be installed until hand tight, then tighten one rotation or when the fitting becomes difficult to return.



17. Install the provided coupler hose (08682) onto the turbo inlet and secure with the provided hose clamp.



18. Connect the crank case vent hose to the fitting installed into the K&N® intake tube and secure with the provided hose clamp.



19. Install the K&N® intake tube into the coupler hose and secure with the provided hose clamp. Connect the waste gate vacuum hose to the vacuum switch and secure with the provided tie wrap.

NOTE: Do not completely tighten the hose clamp at this time to allow some adjusting of the intake tube position.



20. Install the provided filter adapter into the K&N® air filter and secure with the provided hose clamp.



20a. Install the provided foam wrap onto the K&N® air filter.



21. Install the K&N® air filter assembly into the housing and secure with the provided hardware.



22. Install the housing lid onto the housing and secure with the provided hardware.



23. Install the provided hose clamps into the housing bracket as shown.



24. Secure the air filter housing to the bracket with the hose clamps as shown.
NOTE: The housing should be off set in the bracket as shown.



25. Install the coupling hose (08190) onto the filter adapter and secure with the provided hose clamp.



26. Install the factory heat shield onto the K&N® filter assembly then Install the air filter housing assembly, engage the intake tube into the coupler hose and then align the front mounting studs to the factory air filter mounting position. Secure the K&N® housing to the front mounts with the hardware provided. Adjust the intake tube for best fit and then secure all the hose clamps.



27. Install the provided mounting bracket (083110) as shown using the provided hardware.
NOTE: The frame side of the bracket will be secured once the package tray is reinstalled.



28. Install the provided coupler hose (08179) onto the K&N® intake tube and secure with the provided hose clamp.



29. Install the K&N® fresh air intake tube assembly and 90° coupler hose (08502) to the fresh air tube mount and air filter housing, adjust for best fit and the secure with the provided hose clamps.



30. Reinstall the charge air cooler cover and secure with the factory bolts.

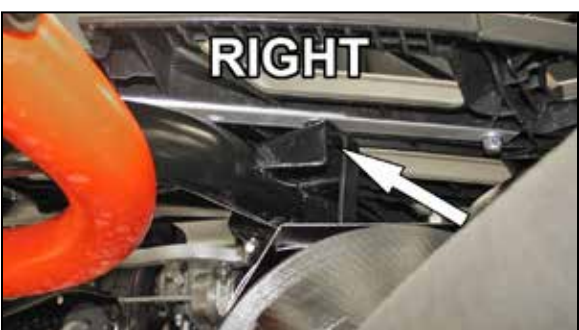

31. Reinstall the package tray and secure with the factory bolts and nuts.
NOTE: The right rear bolt will pass through the air filter housing mounting bracket into the package tray.



32. Reconnect the vehicle's negative battery cable. Double check to make sure everything is tight and properly positioned before starting the vehicle.

33. The C.A.R.B. exemption sticker, (attached), must be visible under the hood so that an emissions inspector can see it when the vehicle is required to be tested for emissions. California requires testing every two years, other states may vary.

34. It will be necessary for all K&N® high flow intake systems to be checked periodically for realignment, clearance and tightening of all connections. Failure to follow the above instructions or proper maintenance may void warranty.

ROAD TESTING:

1. Start the engine with the transmission in neutral or park, and the parking brake engaged. Listen for air leaks or odd noises. For air leaks secure hoses and connections. For odd noises, find cause and repair before proceeding. This kit will function identically to the factory system except for being louder and much more responsive.
2. Test drive the vehicle. Listen for odd noises or rattles and fix as necessary.
3. If road test is fine, you can now enjoy the added power and performance from your kit.
4. K&N Engineering, Inc., requires cleaning the intake system's air filter element every 100,000 miles. When used in dusty or off-road environments, our filters will require cleaning more often. We recommend that you visually inspect your filter once every 25,000 miles to determine if the screen is still visible. When the screen is no longer visible some place on the filter element, it is time to clean it. To clean and re-oil, purchase our filter Recharger® service kit, part number 99-5050 or 99-5000 and follow the easy instructions.

INTAKE SYSTEMS FOR VEHICLES LISTED ARE 50 STATE LEGAL. SEE KNFILTERS.COM FOR CARB STATUS ON EACH PART FOR A SPECIFIC VEHICLE.