



# AIRCHARGER®

## HIGH-FLOW INTAKE KITS

NOT LEGAL FOR SALE OR USE ON ANY POLLUTION CONTROLLED MOTOR VEHICLE IN CALIFORNIA OR STATES ADOPTING CALIFORNIA EMISSION PROCEDURES.  
See knfilters.com for CARB status on each part for a specific vehicle

### INSTALLATION INSTRUCTIONS

**63-1148**  
**Can-am**  
**2024 Maverick R**  
**999Ci Turbo**

- TOOLS NEEDED:**  
Ratchet  
1/4" extension  
8mm socket  
7mm socket  
13mm socket  
4mm allen key  
Flathead screwdriver

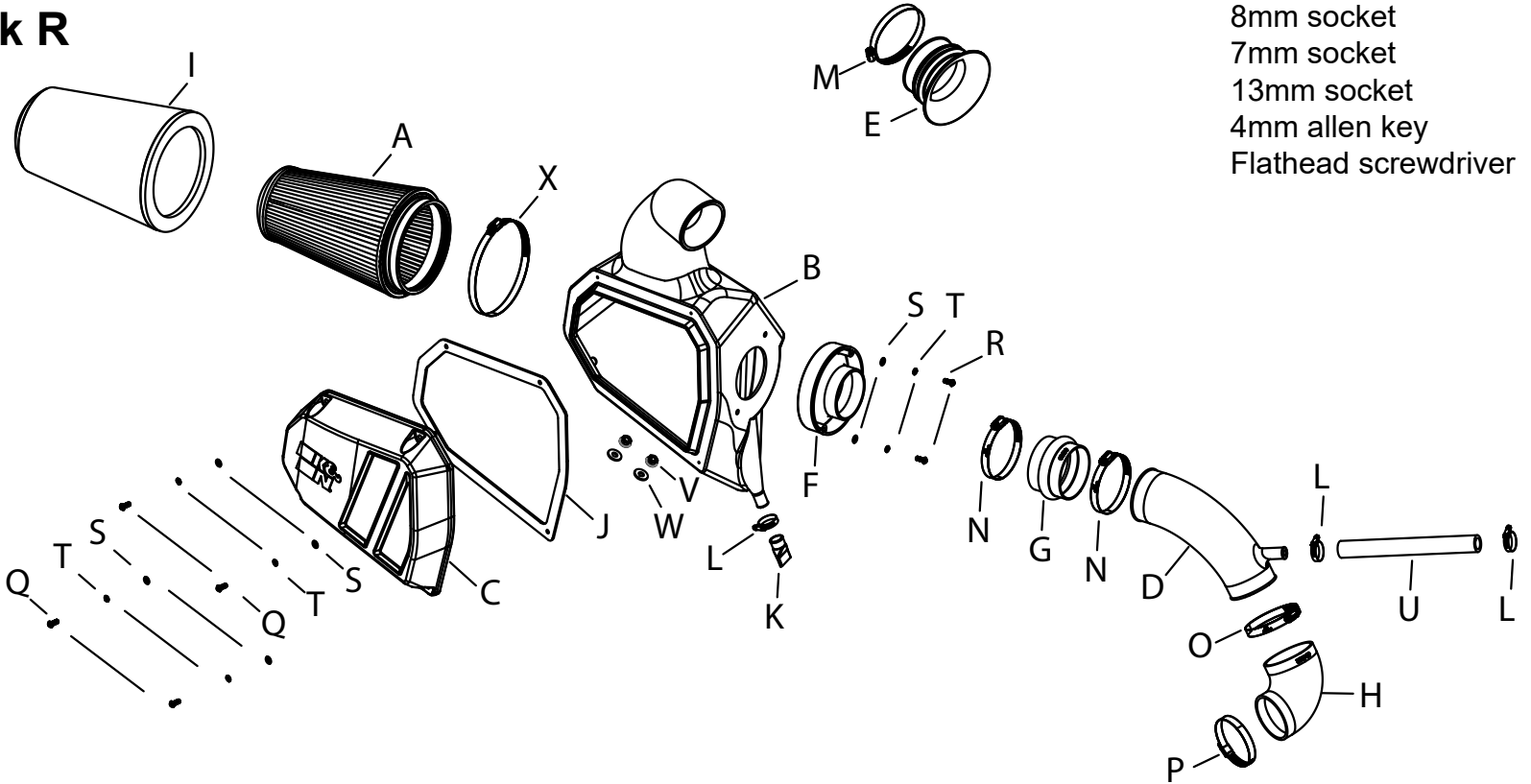

**PARTS LIST:**

Description	Qty.	Part #	Description	Qty.	Part #	Description	Qty.	Part #
A AIR FILTER	1	RU-5064	I PRECLEANER WRAP	1	25-5167	Q BOLT; M6X25MMBUTTON HEAD	4	07729
B AIRBOX	1	087595	J GASKET; LID PORON	1	084198	R BOLT; M6X16MMBUTTON HEAD	2	07730
C LID	1	087596	K HOSE; DUCK BILL	1	08666	S WASHER; 6MM FLAT	6	08269
D TUBE	1	087597	L CLAMP; HOSE , #12 MINI	3	08420	T WASHER; M6, SPLIT LOCK	6	1-3025
E COUPLER; INLET BELL	1	084195	M HOSE CLAMP; #60	1	08624	U HOSE; 3/4"ID X 10"L	1	5-4010
F ADAPTER; FILTER	1	21512-1	N HOSE CLAMP; #56	2	08620	V NUT; 8MM NYLOCK, SS	2	07502
G HOSE; HUMP 3.5"ID X 2.5"L	1	08699	O HOSE CLAMP; #52	1	08610	W WASHER; 5/16"ID X 5/8"OD	2	08276
H HOSE; 3" TO 3-1/4" 90 DEG	1	084102	P HOSE CLAMP; #48	1	08601	X HOSE CLAMP; #104	1	08697

**If you need any assistance please call 1-800-858-3333 to speak with a representative in our Customer Service Center before returning the product.**

**NOTE: FAILURE TO FOLLOW INSTALLATION INSTRUCTIONS AND NOT USING THE PROVIDED HARDWARE MAY DAMAGE THE INTAKE TUBE, THROTTLE BODY AND ENGINE.**

**TO START:**

1. Turn off the ignition and disconnect the negative battery cable.  
**NOTE: Disconnecting the negative battery cable erases pre-programmed electronic memories. Write down all memory settings before disconnecting the negative battery cable. Some radios will require an anti-theft code to be entered after the battery is reconnected. The anti-theft code is typically supplied with your owner's manual. In the event your vehicles anti-theft code cannot be recovered, contact an authorized dealership to obtain your vehicles anti-theft code.**



2. Remove the factory air filter housing mounting bolts shown. Save for later install.



3. Loosen the hose clamp that secures the factory intake tube to the turbo inlet.



4. Loosen the hose clamp that secures the fresh air duct to the factory air filter housing.



5. Remove the factory fresh air intake duct.



6. Loosen the hose clamp that secures the CCV hose to the engine, remove the complete factory intake system.



7. Install the provided filter adapter into the K&N air filter housing and secure with the provided hardware.



8. Install the provided filter wrap onto the K&N air filter.



9. Install the air filter into the K&N air filter housing and secure with the provided hose clamp.



10. Install the supplied "Duck Bill" drain onto the K&N air filter housing and secure with the provided hose clamp.



11. Install the fresh air inlet bell into the stock fresh air-pass hole through the body work.



12. Install the provided CCV hose and elbow coupler onto the K&N intake tube as shown.



13. Install the K&N intake tube assembly onto the turbo inlet and connect the CCV hose to the engine with the provided hose clamps. Tighten clamps on the CCV hose only. Do not secure clamps on elbow coupler.



14. Install the provided hump hose onto the intake tube and secure with the provided hose clamp.



15. Install the K&N air filter assembly into the vehicle so the fresh air duct aligns with the inlet bell installed earlier. Align the intake tube and filter adapter. Using the factory mounting bolts, secure the air filter housing to the chassis using provided hardware. Adjust the intake tube for best fit and then tighten all of the hose clamps.



16. Install the air filter housing lid with the provided hardware and gasket.



17. Reconnect the vehicle's negative battery cable. Double check to make sure everything is tight and properly positioned before starting the vehicle.

18. It will be necessary for all K&N® high flow intake systems to be checked periodically for realignment, clearance and tightening of all connections. Failure to follow the above instructions or proper maintenance may void warranty.

#### ROAD TESTING:

1. Start the engine with the transmission in neutral or park, and the parking brake engaged. Listen for air leaks or odd noises. For air leaks secure hoses and connections. For odd noises, find cause and repair before proceeding. This kit will function identically to the factory system except for being louder and much more responsive.

2. Test drive the vehicle. Listen for odd noises or rattles and fix as necessary.

3. If road test is fine, you can now enjoy the added power and performance from your kit.

4. K&N Engineering, Inc., requires cleaning the intake system's air filter element every 100,000 miles. When used in dusty or off-road environments, our filters will require cleaning more often. We recommend that you visually inspect your filter once every 25,000 miles to determine if the screen is still visible. When the screen is no longer visible some place on the filter element, it is time to clean it. To clean and re-oil, purchase our filter Recharger® service kit, part number 99-5050 or 99-5000 and follow the easy instructions.

**NOT LEGAL FOR SALE OR USE ON ANY POLLUTION CONTROLLED MOTOR VEHICLE IN CALIFORNIA OR STATES ADOPTING CALIFORNIA EMISSION PROCEDURES.**

See [knfilters.com](http://knfilters.com) for CARB status on each part for a specific vehicle