



# AIRCHARGER<sup>®</sup>

## HIGH-FLOW INTAKE KITS

NOT LEGAL FOR SALE OR USE ON ANY POLLUTION CONTROLLED MOTOR VEHICLE IN CALIFORNIA OR STATES ADOPTING CALIFORNIA EMISSION PROCEDURES.  
See knfilters.com for CARB status on each part for a specific vehicle

### INSTALLATION INSTRUCTIONS

**63-9029**  
**TOYOTA / LEXUS**  
**2005-08 4RUNNER**  
**2005-08 GX470**  
**V8-4.7L**

**NOTE:** This kit was not designed to fit vehicles with a body lift.

**TOOLS NEEDED:**

- 2.5mm Allen Wrench
- 10mm Socket
- 12mm Socket
- 13mm Socket
- 10mm Wrench
- 9/16" Wrench
- 5/8" Wrench
- 4mm Allen Wrench
- Extension
- Ratchet
- Flat Blade Screwdriver
- Phillips Screwdriver

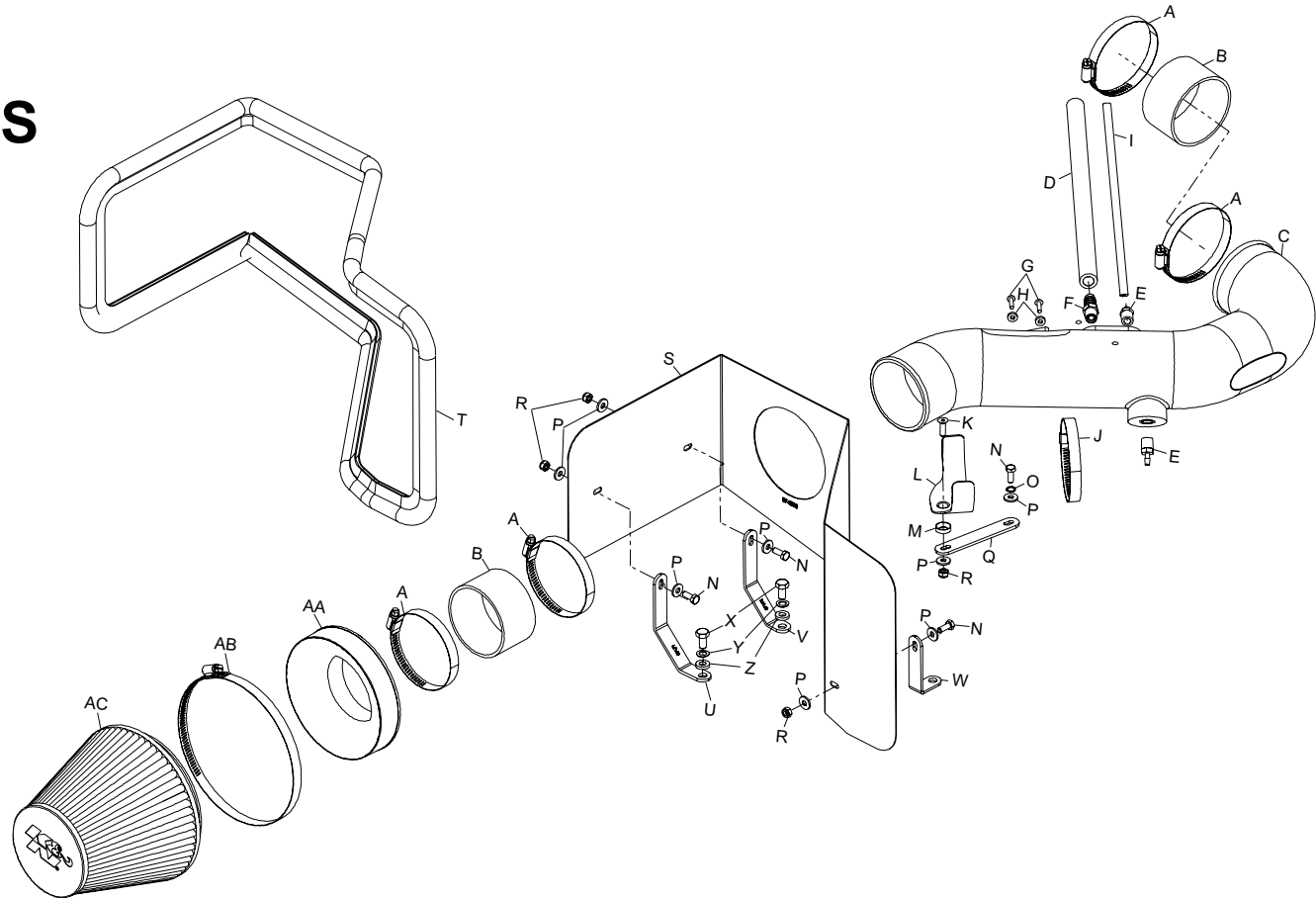

**PARTS LIST:**

Description	Qty.	Part #	Description	Qty.	Part #	Description	Qty.	Part #
A HOSE CLAMP #56	4	08620	K BOLT; M6-1.00 X 20MM	1	08376	U BRACKET; MED "U"	1	07171A
B HOSE; 3.5"ID X 2"L	2	08630	L BRACKET; SADDLE	1	078855	V BRACKET; MED."U"	1	07172
C INTAKE TUBE; (FZ)	1	087198A	M WASHER; CONICAL, NYLON, BLACK	1	08180	W BRACKET; SM."L"	1	07158A
D HOSE; 1/2"ID X 12"L	1	087031	N BOLT; M6-1.00 X 16MM HEX	4	07703	X BOLT; 8MM-1.25 X 16MM HEX	2	07844
E FITTING; 1/4"NPT, 3/16 BARB	2	080021	O WASHER; 1/4" LOCK	1	08198	Y WASHER; 8MM SPRING (WAVE)	2	08239
F VENT; STRT, 1/2" HOSE, 1/4"NPT	1	080022	P WASHER; 1/4"ID X 5/8"OD	8	08275	Z WASHER; 5/16"ID X 5/8"OD, FLAT	2	08276
G SCREW; M4- .7 X 12, BUTTON HEAD	2	07726	Q BRACKET; SHORT	1	07097	AA ADAPTER; 6" FILTER 3.5" COUPLER	1	21512-1
H SPACER; .437"OD X .200"ID X .115"	2	06503	R NUT; 6MM NYLOCK, HEXHEAD	4	07553	AB HOSE CLAMP #104	1	08697
I HOSE; 4MM ID X 18"L	1	08153	S HEAT SHIELD	1	074005	AC AIR FILTER	1	RU-1048
J HOSE CLAMP #52	1	08610	T EDGE TRIM; 83"L	1	102503			

**NOTE: FAILURE TO FOLLOW INSTALLATION INSTRUCTIONS AND NOT USING THE PROVIDED HARDWARE MAY DAMAGE THE INTAKE TUBE, THROTTLE BODY AND ENGINE.**

**TO START:**

1. Turn off the ignition and disconnect the negative battery cable.



2. Loosen the two nuts that secure the throttle body cover then remove the throttle body cover

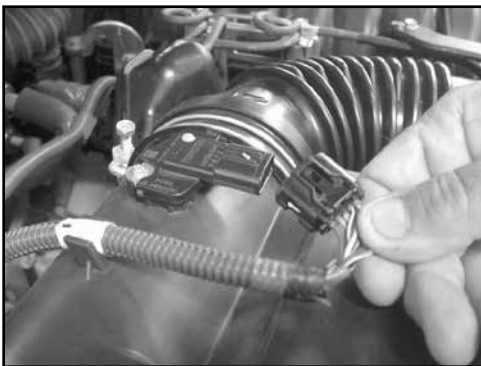

3. Disconnect the mass air sensor electrical connection, and then release the wiring from the air box.

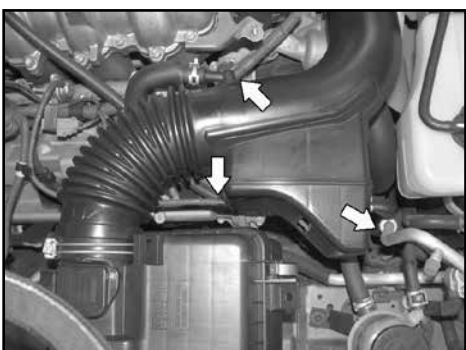

4. Remove the three vent lines from the air intake resonator as shown.



5. Loosen the hose clamp at the throttle body and air box, then remove intake tube from vehicle.



6. Remove the air box lid and filter to gain access to the three bolts that retain the air box to vehicle.

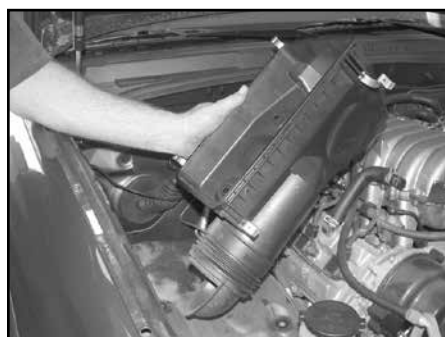

7. Remove the three bolts that retain the air box to vehicle, then remove the air box.  
**NOTE: K&N recommends that customers do not discard factory air intake.**



8. Remove the 12mm bolt that retains the power steering reserve to vehicle then mount the provided bracket (07158) onto the vehicle with the bolt that was removed.



9. Mount the two provided brackets onto the vehicle with the provided hardware.  
**NOTE: Bracket (07172) mounts closest to engine.**



10. Install the edge trim onto the heat shield as shown. Trim if needed.





11. Install the heat shield onto the vehicle then secure to brackets with the provided hardware.

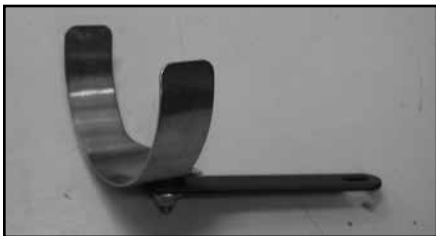

12. Install the saddle bracket assembly with the provided hardware as shown.



13. Install the saddle bracket assembly onto the threaded boss on the cam cover with the provided hardware as shown.



14. Install the provided silicone hose (08630) onto the throttle body with the provided hose clamp.

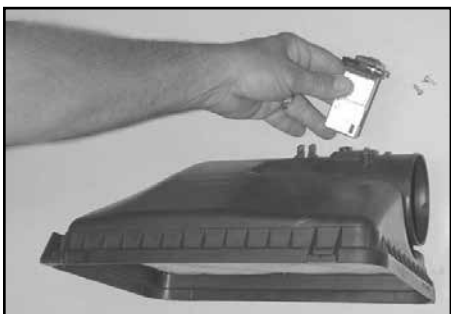

15. Remove the two screws that secure the mass air sensor to the air box lid, and then remove the mass air sensor as shown.



16. Secure the mass air sensor to the K&N® intake tube with the provided screws and spacers.

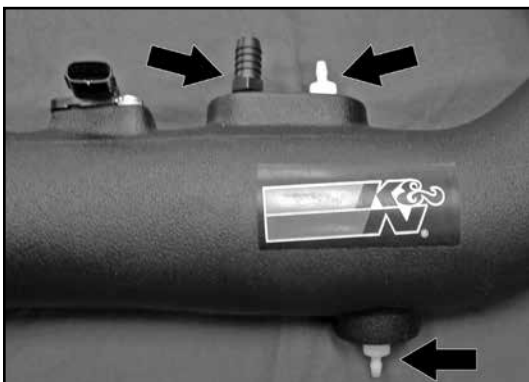

17. Install the vent fittings into the K&N® intake tube as shown.

**NOTE: Plastic NPT fittings are easy to cross thread. Install the vent fitting "hand" tight, then turn it two complete turns with a wrench.**



18. Install the K&N® intake tube onto the throttle body and align with the saddle bracket.



19. Secure the K&N® intake tube to the saddle bracket with the provided hose clamps also tighten the hose clamp at the throttle body.

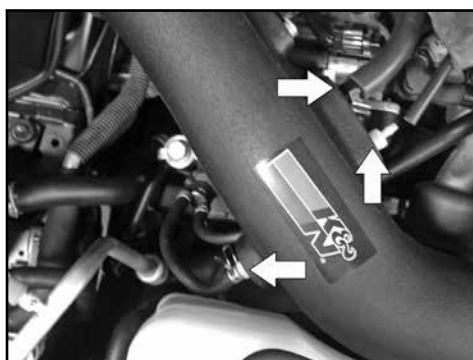

20. Install the supplied crank case vent and fuel pressure regulator vent hose's onto the engine and connect to the K&N® intake tube as shown. Connect the factory power steering pressure switch vent onto the K&N intake tube.



21. Install the filter adapter into the K&N® Air filter assembly and secure with the provided hose clamp.

**NOTE: Drycharger® air filter wrap; part # RF-1048DK is available to purchase separately. To learn more about Drycharger® filter wraps or look up color availability please visit <http://www.knfilters.com>.**



22. Install the silicone hose (08630) onto the K&N® Air filter assembly and secure with the provided hose clamp.



23. Install the K&N® Air filter onto the intake tube as shown and secure with the provided hose clamp.



24. Disconnect the ground strap that's attached to the mass air sensor wiring harness at the inner fender as shown.



25. Using the bolt that was removed in the previous step, connect the ground strap to wheel well as shown.



26. Reconnect the mass air sensor electrical connections.



27. Re-install the throttle body cover as shown.



28. Reconnect the vehicle's negative battery cable. Double check to make sure everything is tight and properly positioned before starting the vehicle.

29. It will be necessary for all K&N® intake kits to be checked periodically for realignment, clearance and tightening of all connections. Failure to follow the above instructions or proper maintenance may void warranty.

#### ROAD TESTING:

1. Start the engine with the transmission in neutral or park, and the parking brake engaged. Listen for air leaks or odd noises. For air leaks secure hoses and connections. For odd noises, find cause and repair before proceeding. This kit will function identically to the factory system except for being louder and much more responsive.

2. Test drive the vehicle. Listen for odd noises or rattles and fix as necessary.

3. If road test is fine, you can now enjoy the added power and performance from your kit.

4. K&N suggests checking the air filter element periodically for excessive dirt build-up. When the element becomes covered in dirt (or once a year), service it according to the instructions on the Recharger service kit, part number 99-5050 or 99-5000.

**NOT LEGAL FOR SALE OR USE ON ANY POLLUTION CONTROLLED MOTOR VEHICLE IN CALIFORNIA OR STATES ADOPTING CALIFORNIA EMISSION PROCEDURES.**

See [knfilters.com](http://knfilters.com) for CARB status on each part for a specific vehicle