



NOT LEGAL FOR SALE OR USE ON ANY POLLUTION CONTROLLED MOTOR VEHICLE IN CALIFORNIA OR STATES ADOPTING CALIFORNIA EMISSION PROCEDURES.
See knfilters.com for CARB status on each part for a specific vehicle

INSTALLATION INSTRUCTIONS

77-1587KC

JEEP

2021-24 Grand Cherokee L

2022-24 Grand Cherokee

V6-3.6L F/L

TOOLS NEEDED:

Flat blade screw driver
Ratchet
Extension
10mm socket
8mm socket
4mm socket
Side cutters

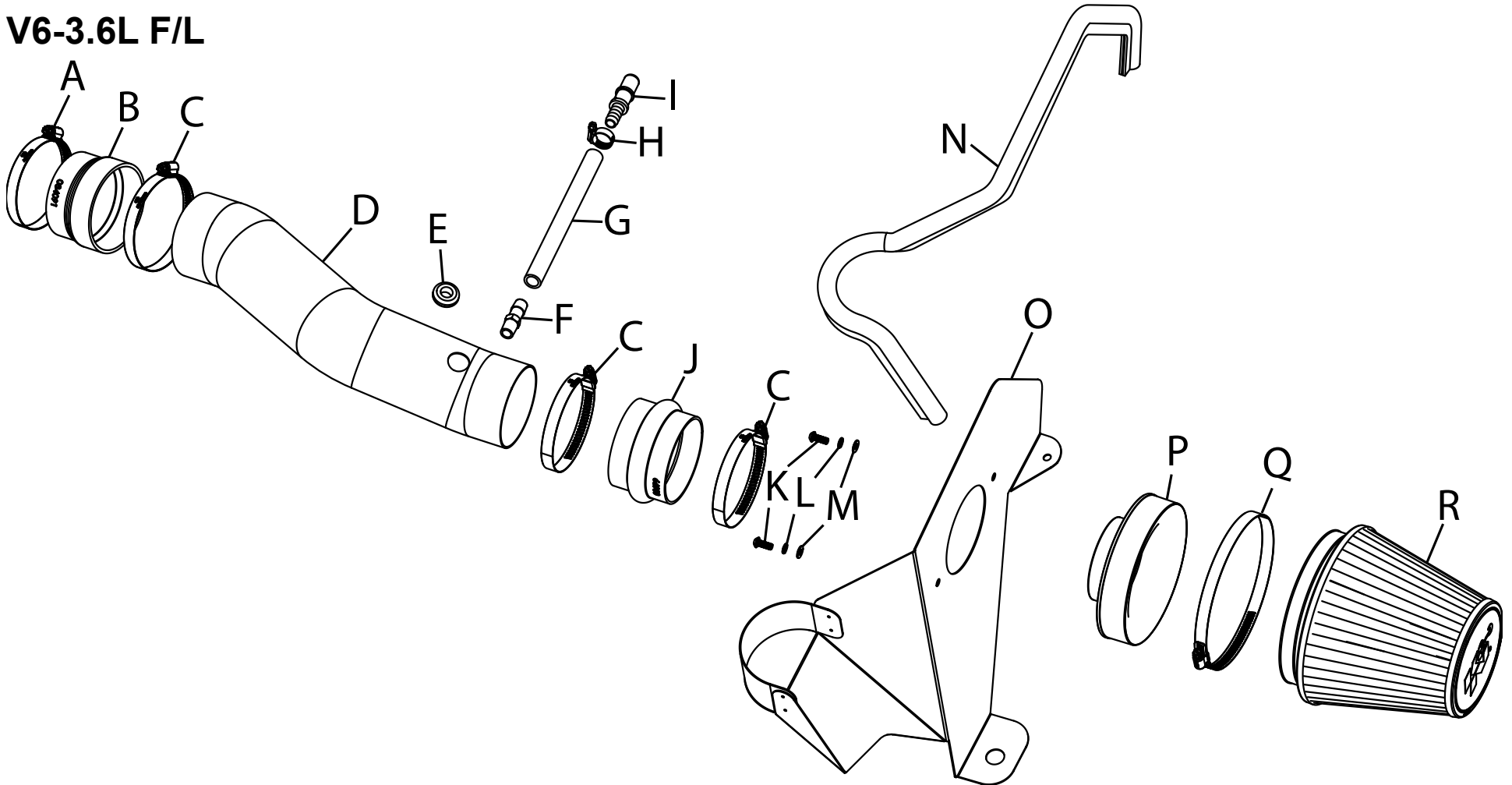

If you need any assistance please call 1-800-858-3333 to speak with a representative in our Customer Service Center before returning the product.

PARTS LIST:

Description	Qty.	Part #	Description	Qty.	Part #	Description	Qty.	Part #
A HOSE CLAMP; #52	1	08610	G HOSE; 1/2"ID X 8"L	1	5-5008	M WASHER; 6MM FLAT	2	08269
B HOSE; 3.25"ID TO 3.5"ID X 2.25"L BLK	1	084091	H HOSE CLAMP; #6 MINI	1	08407	N EDGE TRIM; (61"L)	1	102492
C HOSE CLAMP; #56	3	08620	I VENT; 1/2" BARB TO 5/8"OD	1	82629	O HEAT SHIELD	1	074556
D INTAKE TUBE; 3.5"OD X 16"L	1	25886C	J HOSE; HUMP 3.5"ID X 2.5"L	1	08699	P ADAPTOR; MAF SENSOR	1	21512-1
E GROMMET; 1-1/16OD, 1/2ID, 3/8THK	1	080544	K BOLT; M6 X 1 X 16MM, BTNHD	2	07730	Q HOSE CLAMP; #104	1	08697
F VENT; 1/2"HOSE, 1/4"NPT	1	080022	L WASHER; M6, SPLIT LOCK	2	1-3025	R AIR FILTER	1	RU-1042

NOTE: FAILURE TO FOLLOW INSTALLATION INSTRUCTIONS AND NOT USING THE PROVIDED HARDWARE MAY DAMAGE THE INTAKE TUBE, THROTTLE BODY AND ENGINE.

TO START:

1. Turn off the ignition and disconnect the negative battery cable.
NOTE: Disconnecting the negative battery cable erases pre-programmed electronic memories. Write down all memory settings before disconnecting the negative battery cable. Some radios will require an anti-theft code to be entered after the battery is reconnected. The anti-theft code is typically supplied with your owner's manual. In the event your vehicles anti-theft code cannot be recovered, contact an authorized dealership to obtain your vehicles anti-theft code.



2. Remove the two bolts that secure the engine cover and then remove the cover from the vehicle.



3. Disconnect the IAT sensor electrical connection and unhook the wiring harness from the factory intake tube. Loosen the two hose clamps that secure the intake tube to the throttle body and air filter housing.



4. Remove the nut that secures the intake tube to the mounting bracket and then disconnect the CCV hose connector. Remove the intake tube from vehicle.

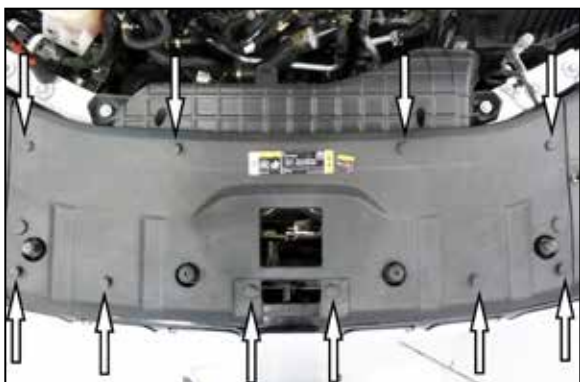

5. Remove the ten retaining clips that secure the radiator cover and then remove the cover from the vehicle.



6. Remove the two bolts that secure the fresh air duct and then remove the duct from the vehicle.



7. Loosen the four bolts that secure the upper air filter housing, remove the upper housing and factory air filter.



8. Remove the two bolts that secure the lower air filter housing and then remove the housing from the vehicle.

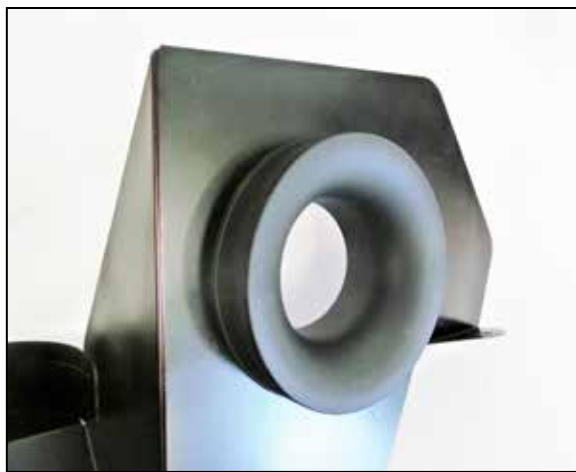

9. Install the radius filter adapter into the heatshield and secure with the provided hardware.



10. Remove one of the mounting grommets from the factory lower air filter housing and install it into the heatshield.



11. Install the edge trim around the heatshield as shown. **NOTE: some trimming of the edge trim will be necessary.**



12. Install the heatshield into the vehicle so the mounting grommet engages the mounting stud and then secure the heatshield with one of the factory air filter housing mounting bolts.



13. Reinstall the fresh air intake duct and align with the heatshield.



14. Reinstall the radiator cover and secure with the factory mounting pins.



15. Release the locking tab on the IAT sensor and then rotate and remove the sensor from the factory intake tube.



16. Install the IAT sensor into the K&N intake tube using the grommet provided.



17. Assemble the CCV hose extension as shown.



18. Install the CCV extension into the K&N intake tube as shown. **NOTE: The fitting threaded into the tube is 1/4"npt, do not over tighten.**



19. Install the provided couplers and secure with the provided hose clamps, The hump coupler goes onto the filter adapter and the straight coupler attaches to the throttle body.



20. Install the intake tube into the couplers, adjust for best fit and then secure with the hose clamps.



21. Connect the CCV extension to the factory CCV quick connect.



22. Reconnect the IAT sensor electrical connection.



23. Install the air filter onto the filter adapter and secure with the provided hose clamp.



24. Reinstall the engine cover and secure with the factory hardware.



25. Apply the K&N decal onto the intake tube.



26. Reconnect the vehicle's negative battery cable. Double check to make sure everything is tight and properly positioned before starting the vehicle.

27. It will be necessary for all K&N® high flow intake systems to be checked periodically for realignment, clearance and tightening of all connections. Failure to follow the above instructions or proper maintenance may void warranty.

ROAD TESTING:

1. Start the engine with the transmission in neutral or park, and the parking brake engaged. Listen for air leaks or odd noises. For air leaks secure hoses and connections. For odd noises, find cause and repair before proceeding. This kit will function identically to the factory system except for being louder and much more responsive.

2. Test drive the vehicle. Listen for odd noises or rattles and fix as necessary.

3. If road test is fine, you can now enjoy the added power and performance from your kit.

4. K&N Engineering, Inc., requires cleaning the intake system's air filter element every 100,000 miles. When used in dusty or off-road environments, our filters will require cleaning more often. We recommend that you visually inspect your filter once every 25,000 miles to determine if the screen is still visible. When the screen is no longer visible some place on the filter element, it is time to clean it. To clean and re-oil, purchase our filter Recharger® service kit, part number 99-5050 or 99-5000 and follow the easy instructions.

NOT LEGAL FOR SALE OR USE ON ANY POLLUTION CONTROLLED MOTOR VEHICLE IN CALIFORNIA OR STATES ADOPTING CALIFORNIA EMISSION PROCEDURES.

See knfilters.com for CARB status on each part for a specific vehicle