



INTAKE SYSTEMS FOR VEHICLES LISTED ARE 50 STATE LEGAL. SEE KNFILTERS.COM FOR CARB STATUS ON EACH PART FOR A SPECIFIC VEHICLE.

# INSTALLATION INSTRUCTIONS

## 77-3050KP CHEVROLET / GMC / CADILLAC

2007 Silverado / Sierra Classic 1500

V8-4.8L / 5.3L / 6.0L

2007 Silverado Classic SS

V8-6.0L

2005-06 Silverado / Sierra

V8-4.8L / 5.3L

2005-06 Silverado SS

V8-6.0L

2005-06 Tahoe / Yukon

V8-4.8L / 5.3L

2005-06 Suburban / Yukon XL

V8-5.3L

2005-06 Yukon Denali / Denali XL

V8-6.0L

2005-06 Sierra Denali

V8-6.0L

2005-06 Avalanche

V8-5.3L

2005-06 Escalade

V8-5.3L

2006 Escalade

V8-6.0L

2005 Escalade EXT / ESV

V8-6.0L

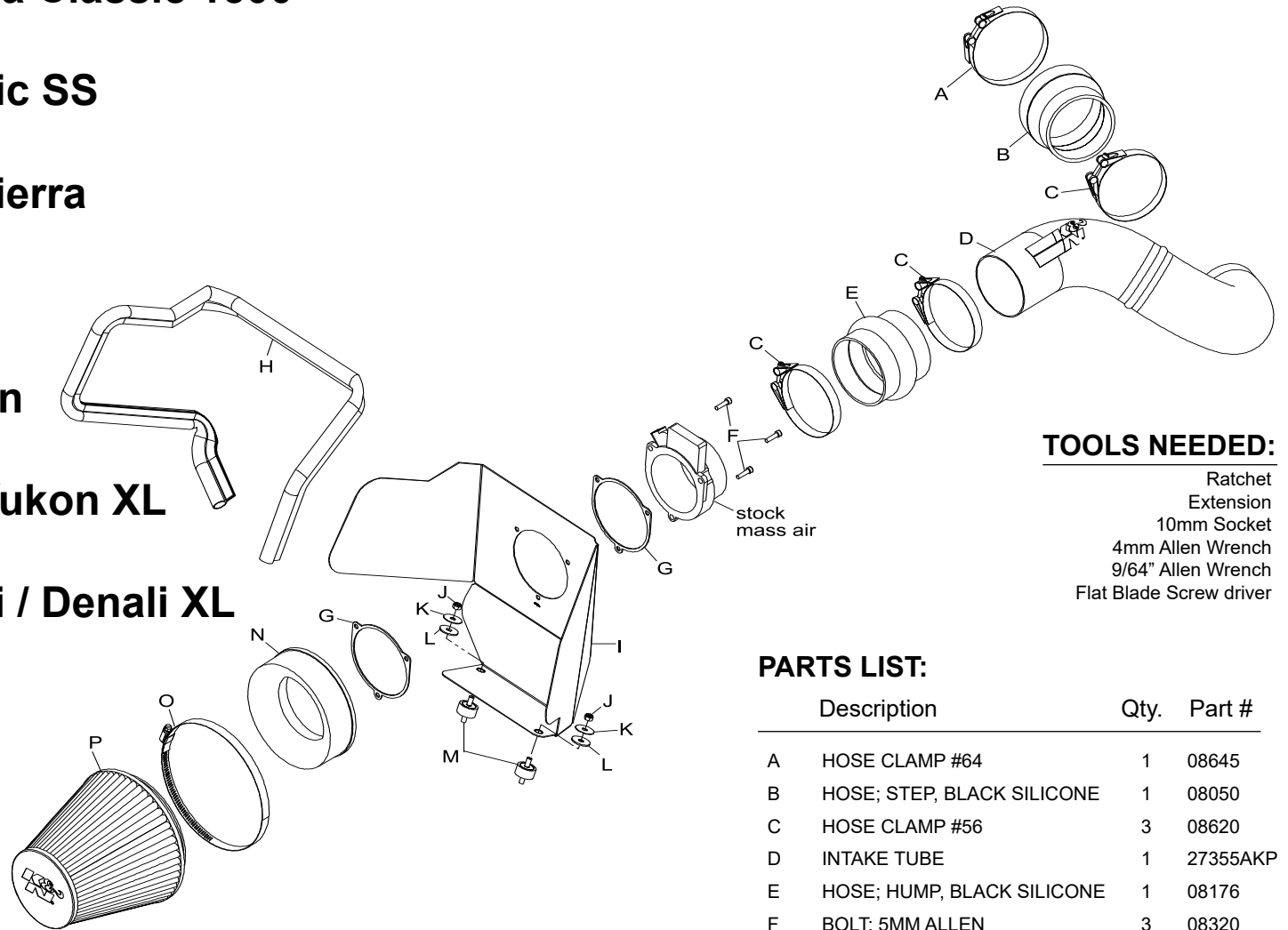

### TOOLS NEEDED:

- Ratchet
- Extension
- 10mm Socket
- 4mm Allen Wrench
- 9/64" Allen Wrench
- Flat Blade Screw driver

### PARTS LIST:

Description	Qty.	Part #
A HOSE CLAMP #64	1	08645
B HOSE; STEP, BLACK SILICONE	1	08050
C HOSE CLAMP #56	3	08620
D INTAKE TUBE	1	27355AKP
E HOSE; HUMP, BLACK SILICONE	1	08176
F BOLT; 5MM ALLEN	3	08320
G GASKET; MASS AIR	2	09033
H EDGE TRIM 50"	1	102481
I HEAT SHIELD	1	07316
J NUT; 6MM NYLOCK	2	07553
K WASHER; FENDER	2	08160
L WASHER; RUBBER	2	21685
M STUD; 6MM-1.00, RUB.	2	07027
N ADAPTER #240	1	08783
O HOSE CLAMP #104	1	08697
P AIR FILTER	1	RU-1041

NOTE: This kit was not designed to fit vehicles with a body lift.

If you need any assistance please call 1-800-858-3333 to speak with a representative in our Customer Service Center before returning the product.

NOTE: FAILURE TO FOLLOW INSTALLATION INSTRUCTIONS AND NOT USING THE PROVIDED HARDWARE MAY DAMAGE THE INTAKE TUBE, THROTTLE BODY AND ENGINE.

### TO START:

1. Turn off the ignition and disconnect the negative battery cable.  
**NOTE: Disconnecting the negative battery cable erases pre-programmed electronic memories. Write down all memory settings before disconnecting the negative battery cable. Some radios will require an anti-theft code to be entered after the battery is reconnected. The anti-theft code is typically supplied with your owner's manual. In the event your vehicles' anti-theft code cannot be recovered, contact an authorized dealership to obtain your vehicles anti-theft code.**



2. Disconnect the mass air sensor electrician connection.

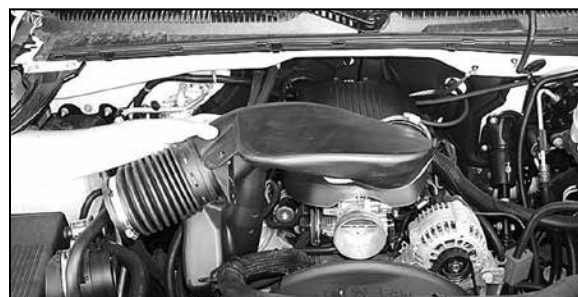

3. Loosen the hose clamps at the throttle body and at the mass air sensor, then remove the factory intake tube as shown.



4. Pull firmly upwards to release the air cleaner assembly from the mounting tray grommets, then remove the assembly.  
**NOTE: K&N Engineering, Inc., recommends that customers do not discard factory air intake.**

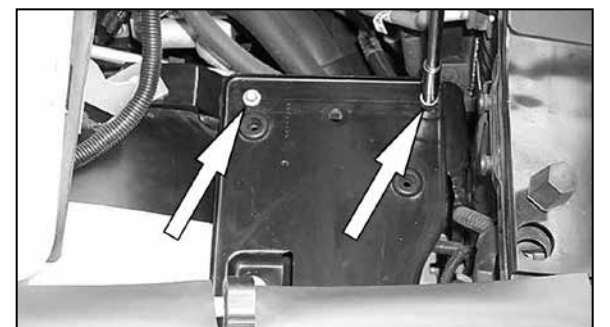

5. Loosen and remove the two air cleaner mounting tray bolts as shown.

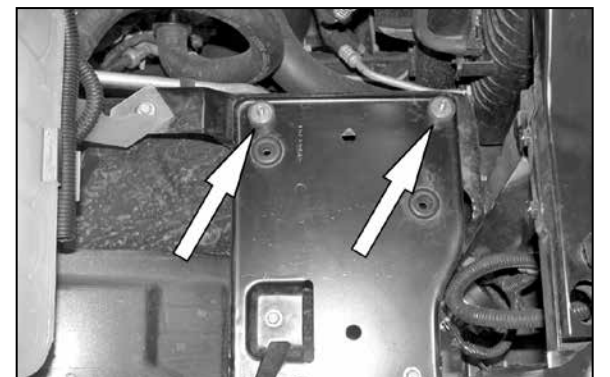

6. Install the rubber mounted studs onto the previous bolt locations removed in step #5



7. Loosen the hose clamp and remove the mass air sensor from the air cleaner.



8. Apply the trim seal to the heat shield assembly as shown.



9. Assemble the mass air adapter, heat shield, gaskets and the mass air sensor as shown above.



10. Install the heat shield assembly onto the rubber mounted studs using the hardware provided.



11. Install the silicone hose (08050) and hose clamps onto the throttle body as shown.



12. Install the silicone hump hose (08176) and hose clamps onto the K&N® intake tube as shown.



13. Install the K&N® intake tube onto the mass air sensor, then secure the other end onto the throttle body as shown.



14. Adjust the heat shield and intake tube for best fit, then tighten the two nuts as shown.



15. Install the K&N® air filter onto the heat shield assembly as shown.

**NOTE: Drycharger® air filter wrap; part # RF-1041DK is available to purchase separately. To learn more about Drycharger® filter wraps or look up color availability please visit <http://www.knfilters.com>®.**



16. Reconnect the mass air sensor electrical connection as shown.



17. Reconnect the vehicle's negative battery cable. Double check to make sure everything is tight and properly positioned before starting the vehicle.

18. The C.A.R.B. exemption sticker, (attached), must be visible under the hood so that an emissions inspector can see it when the vehicle is required to be tested for emissions. California requires testing every two years, other states may vary.

19. It will be necessary for all K&N® high flow intake systems to be checked periodically for realignment, clearance and tightening of all connections. Failure to follow the above instructions or proper maintenance may void warranty.

#### ROAD TESTING:

1. Start the engine with the transmission in neutral or park, and the parking brake engaged. Listen for air leaks or odd noises. For air leaks secure hoses and connections. For odd noises, find cause and repair before proceeding. This kit will function identically to the factory system except for being louder and much more responsive.

2. Test drive the vehicle. Listen for odd noises or rattles and fix as necessary.

3. If road test is fine, you can now enjoy the added power and performance from your kit.

4. K&N Engineering, Inc., requires cleaning the intake system's air filter element every 100,000 miles. When used in dusty or off-road environments, our filters will require cleaning more often. We recommend that you visually inspect your filter once every 25,000 miles to determine if the screen is still visible. When the screen is no longer visible some place on the filter element, it is time to clean it. To clean and re-oil, purchase our filter Recharger® service kit, part number 99-5050 or 99-5000 and follow the easy instructions.

**INTAKE SYSTEMS FOR VEHICLES LISTED ARE 50 STATE LEGAL. SEE KNFILTERS.COM FOR CARB STATUS ON EACH PART FOR A SPECIFIC VEHICLE.**

\* FREE K&N® decal To register your warranty, please see us online at [knfilters.com/register](http://knfilters.com/register). FREE K&N® decal \*