



## INTAKE SYSTEM

# INSTALLATION INSTRUCTIONS

### 26-3008C

### BMW

### 2018-20 M2

### 2015-20 M3

### 2015-20 M4

### L6-3.0L

NOT LEGAL FOR SALE OR USE ON ANY POLLUTION CONTROLLED MOTOR VEHICLE IN CALIFORNIA OR STATES ADOPTING CALIFORNIA EMISSION PROCEDURES.

See [aemintakes.com](http://aemintakes.com) for CARB status on each part for a specific vehicle

#### TOOLS NEEDED:

Flat blade screwdriver  
Ratchet  
Extension  
13mm socket  
10mm socket  
T50 TORX wrench  
5/16" 12-point wrench  
8mm 12-point wrench

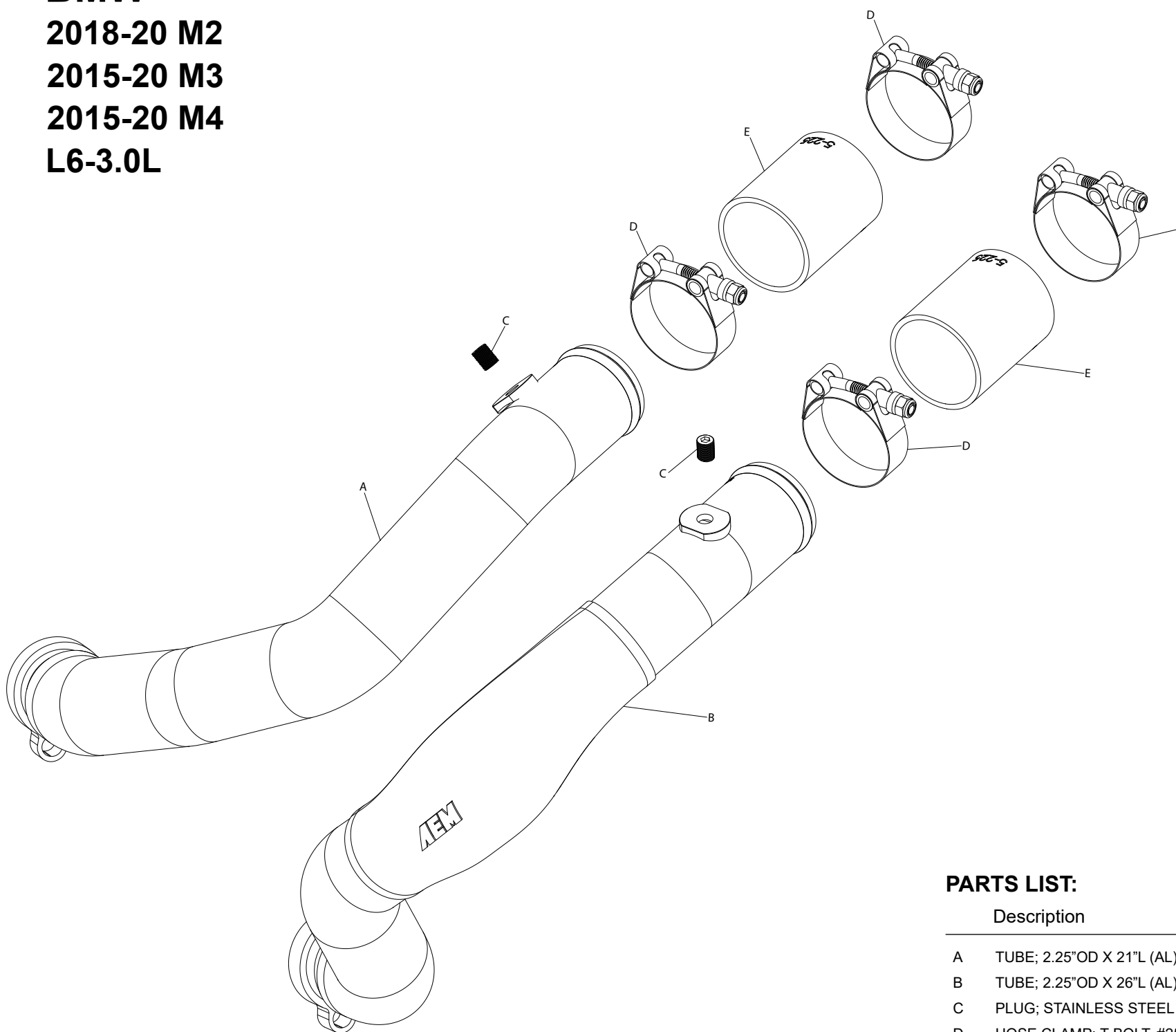

#### PARTS LIST:

	Description	Qty.	Part #
A	TUBE; 2.25"OD X 21"L (AL)	1	25856C
B	TUBE; 2.25"OD X 26"L (AL)	1	25855C
C	PLUG; STAINLESS STEEL 1/8" NPT	2	1-1014
D	HOSE CLAMP; T-BOLT, #256 or #262	4	21812
E	HOSE; 2.25" X 3" BLACK SILICONE	2	5-225

If you need any assistance please call 1-800-858-3333 to speak with a representative in our Customer Service Center before returning the product.

Read and understand these instructions **BEFORE** attempting to install this product. Failure to follow installation instructions and not using the provided hardware may damage the intake tube, throttle body and engine.

#### TO START:

1. Turn off the ignition and disconnect the negative battery cable.

**NOTE:** Disconnecting the negative battery cable erases pre-programmed electronic memories. Write down all memory settings before disconnecting the negative battery cable. Some radios will require an anti-theft code to be entered after the battery is reconnected. The anti-theft code is typically supplied with your owner's manual. In the event your vehicles anti-theft code cannot be recovered, contact an authorized dealership to obtain your vehicles anti-theft code.



2. Remove the retaining pin and turn the three fasteners 1/4 turn counterclockwise to unlock, then remove the cover panels from the vehicle.



3. Remove the six bolts that secure the strut tower brace and then remove the brace from the vehicle.



4. Remove the oil fill cap and then lift off the engine cover. Reinstall the oil fill cap or use a towel to keep debris from entering the engine.



5. Disconnect the maf sensor electrical connection. Loosen the hose clamp that secures the factory intake tube to the air filter housing and then remove the air filter housing from the vehicle. Loosen the hose clamp that secures the factory intake tube to the turbo inlet pipe and then remove the tube from the vehicle. Stuff a towel into the turbo inlet pipe to prevent debris from falling into the turbo.



6. Remove the bolt that secures the turbo inlet pipe and then disconnect the pipe from the turbo and remove it from the vehicle.



7. Loosen the four hose clamps that secure the factory charge tube hoses to the intercooler.



8. Remove the bolts that secure the factory charge tubes to the turbo and then remove the charge tubes from the vehicle. NOTE: The following size wrenches can be used to remove the TORX bolts, T50 TORX, 5/16" 12-point wrench, 8mm 12-point wrench.



9. Remove the O-rings from the factory charge tubes and install them into the AEM charge tubes.

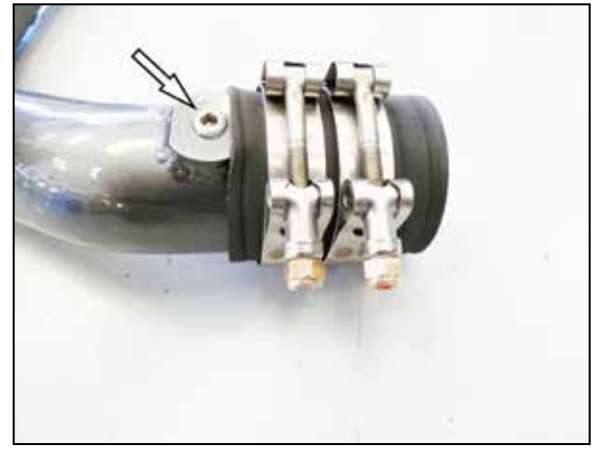

10. Install the provided 1/8npt accessory port plugs into the AEM charge tubes. NOTE: be sure to apply pipe sealant on the threads of the plugs. Install the provided couplers and clamps onto the charge tubes. NOTE: Slide the couplers all the way onto the pipes as shown as this will aid the installation of the pipes.



11. Install the AEM charge pipes onto the turbo and secure with the factory hardware from step #8.



12. Slide the couplers onto the intercooler inlets, position the hose clamps and then tighten.



13. Reinstall the turbo inlet and secure with the factory hardware.



14. Install the factory intake tube onto the turbo inlet and secure with the factory clamp.



15. Reinstall the air filter housing, secure the intake tube with the factory hose clamp and reconnect the maf sensor electrical connection.



16. Reinstall the engine cover and oil fill cap.



17. Reinstall the strut tower brace and covers, secure with the factory hardware.

### 18. Reassemble Vehicle

Position the inlet pipes for the best fitment. Be sure that the pipes or any other components do not contact any part of the vehicle. Tighten the rubber mount, all bolts, and hose clamps. Check for proper hood clearance. Re-adjust pipes if necessary and re-tighten them. Inspect the engine bay for any loose tools and check that all fasteners that were moved or removed are properly tightened. Reconnect negative battery terminal and start engine. Let the vehicle idle for 3 minutes. Perform a final inspection before driving the vehicle.

### Service and Maintenance

AEM Induction Systems requires cleaning the intake system's air filter element every 100,000 miles. When used in dusty or off-road environments, our filters will require cleaning more often. We recommend that you visually inspect your filter once every 25,000 miles to determine if the screen is still visible. When the screen is no longer visible some place on the filter element, it is time to clean it. To clean, purchase our Synthetic air filter cleaner, part number AEM-1-1000 and follow the easy instructions. Use window cleaner to clean your powder coated AEM® intake tube.

**NOTE: DO NOT USE aluminum polish on powder coated AEM® intake tubes.**

NOT LEGAL FOR SALE OR USE ON ANY POLLUTION CONTROLLED MOTOR VEHICLE IN CALIFORNIA OR STATES ADOPTING CALIFORNIA EMISSION PROCEDURES.

See [aemintakes.com](http://aemintakes.com) for CARB status on each part for a specific vehicle

### AEM Air Intake System Warranty Policy

AEM® warrants that its intake systems will last for the life of your vehicle. AEM will not honor this warranty due to mechanical damage (i.e. improper installation or fitment), damage from misuse, accidents or flying debris. AEM will not warrant its powder coating if the finish has been cleaned with a hydrocarbon-based solvent. The powder coating should only be cleaned with a mild soap and water solution. Proof of purchase of both the vehicle and AEM intake system is required for redemption of a warranty claim.

This warranty is limited to the repair or replacement of the AEM part. In no event shall this warranty exceed the original purchase price of the AEM part nor shall AEM be responsible for special, incidental or consequential damages or cost incurred due to the failure of this product. Warranty claims to AEM must be transportation prepaid and accompanied with dated proof of purchase. This warranty applies only to the original purchaser of product and is nontransferable. Improper use or installation, use for racing, accident, abuse, unauthorized repairs or alterations voids this warranty. AEM disclaims any liability for consequential damages due to breach of any written or implied warranty on all products manufactured by AEM. Warranty returns will only be accepted by AEM when accompanied by a valid Return Merchandise Authorization (RMA) number. Credit for defective products will be issued pending inspection. Product must be received by AEM within 30 days of the date RMA is issued.

If you have a warranty issue, please call (800) 992-3000 and our customer service department will assist you. A proof of purchase is required for all AEM warranty claims.