



## # 200-585-1 INSTALLATION INSTRUCTIONS

**04-09 Chevrolet Colorado/GMC Canyon  
2006-07 Isuzu i-280, i-290,2.8,2.9L I4**

**2007-13 Chevrolet Silverado 4.3L V-6  
2007-13 GMC Sierra 4.3L V-6**

Thank you for purchasing the Airaid Throttle Body Spacer. Please read the instruction manual carefully before proceeding with the installation. Your Airaid Throttle Body Spacer was carefully inspected and packaged. Check that no parts are missing, or were damaged during shipping. If you need any assistance please call 1-800-858-3333 to speak with a representative in our Customer Service Center before returning the product.

*Thank you for selecting AIRAID.*

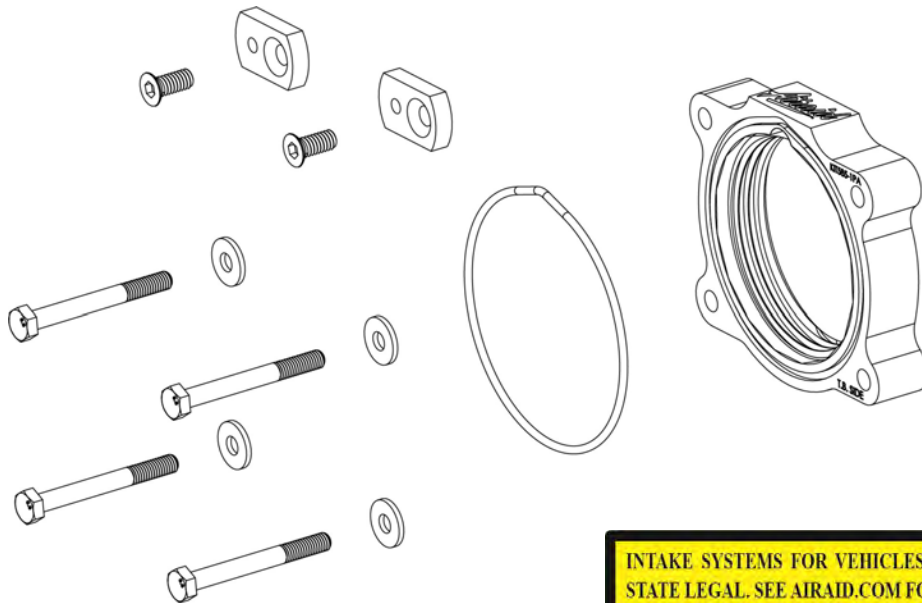

**INTAKE SYSTEMS FOR VEHICLES LISTED ARE 50 STATE LEGAL. SEE AIRAID.COM FOR CARB STATUS ON EACH PART FOR A SPECIFIC VEHICLE.**

Also available: the AIRAID Intake System. Call for details!

### **Parts List**

AIR-KIT585-1PA	Aluminum Plate	(1)
AIR-KIT585-1H	Hardware	
	"O" Ring	(1)
	6mm x 60mm Bolts	(4)
	6mm Flat Washers	(4)
	Extension Plates	(2)
	6mm x 20mm Flat Head Screws	(2)

### **Tools List**

5/16" Socket (Hose clamps)  
10mm Socket  
4mm Socket (stud removal)  
Ratchet & Extension  
4mm Allen Wrench

## ***Installation Instructions. Read Me!***

1. **DISCONNECT NEGATIVE (-) BATTERY CABLE.**
2. Loosen the hose clamp and remove the intake hose on the left front corner of the resonator box. Remove 2 bolts on the passenger side of the resonator. (Ref. "D")
3. Loosen the hose clamp on the throttle body and carefully work loose, lift the resonator and rotate it to the left.  
\* **Use caution to remove the breather hose connected to the valve cover.**
4. Remove the air intake system and throttle body. (Ref. B) Remove 4 studs from intake manifold.
5. Install power plate with the o-ring side of plate facing the throttle body, use supplied (4) 6mm x 60mm bolts and flat washers. (Ref A & C)
6. \* **2.8L, & 2.9L engine-** Install (2) extension plates using (2) 6mm x 20mm flat head screws. (Ref. D)  
\* **Please Note- Extension plates are not necessary for 4.3L engines.**
7. Inspect & Test throttle linkage for full Open & Closed travel before driving. Some cruise or kickdown cables may require adjustment. Please refer to the vehicles service manual for proper adjustment.
8. Reinstall the air intake system using (Steps 2&3) as an example. **Make sure to reconnect the crankcase breather hose!**
9. Reconnect negative battery cable. Enjoy!

Ref. "B"- Throttle Body

4.3L- Similar install, but not shown.



Ref. "A"- (1) Power Plate  
(1) "O" Ring

Ref. "C"- (4) 6mm x 60mm Bolts  
(4) 6mm Flat Washers

Ref. "D"- (2) Extension Plates  
(2) 6mm x 20mm Flat Head Screws

AIR-I20585-1C  
Rev. 06.29.20