

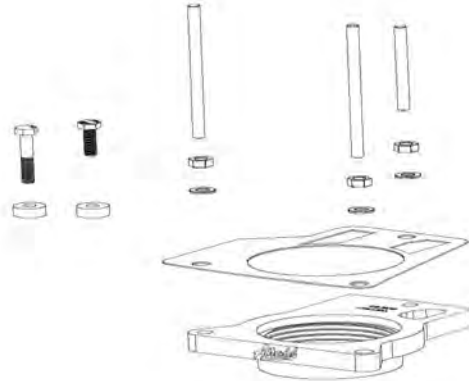

Installation Instructions
Part Number 200-615
Airaid Spacer For 2001-07
Chevy Silverado/Silverado "Classic"
GMC Sierra/Sierra "Classic"
4.3L V6



Parts List

AIR-KIT615PA	Aluminum Plate	(1)
AIR-KIT615G	Gasket	(1)
AIR-KIT615H	Hardware	
	6mmx114mm Stud	(2)
	6mmx70mm Stud	(1)
	6mmx30mm bolt	(1)
	6mmx35mm bolt	(1)
	6mm Flat Washer	(3)
	6mm Nut	(3)
	1/2" Long Round Spacer	(2)

THROTTLE BODY SPACERS FOR VEHICLES LISTED ARE 50 STATE LEGAL. SEE AIRAID.COM FOR CARB STATUS ON EACH PART FOR A SPECIFIC VEHICLE.

Tools Required For Installation

- 10mm Deep Well Socket
- 4mm Socket or Wrench
- 6mm 12 Point Wrench
- 8mm Wrench
- 5/16" Socket

Thank you for purchasing the Airaid Throttle Body Spacer. Please read the instruction manual carefully before proceeding with the installation. Your Airaid Throttle Body Spacer was carefully inspected and packaged. Check that no parts are missing, or were damaged during shipping. If you need any assistance please call 1-800-858-3333 to speak with a representative in our Customer Service Center before returning the product.
Thank you for selecting AIRAID.



1. Disconnect the negative battery cable!
Loosen the hose clamps on the factory intake tube. Remove the intake tube and set it aside.



2. Disconnect the breather hose elbow from the intake hat.
Remove the intake hat, and hold down nut, and save them for reuse.

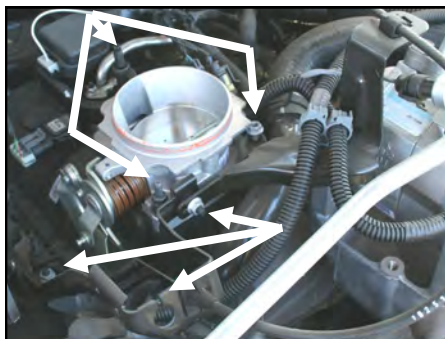

3. With a 10mm deep well socket, remove the throttle body, throttle cable support bracket, and throttle cable bracket nuts. Using a 6mm 12 point socket, remove the rear stud from the throttle body. Disconnect the harness plugs on the throttle body.



4. Set the throttle body and brackets aside. Remove the factory throttle body studs. Install two 6mm x 114mm studs in the front mounting holes, and one 6mm x 70mm stud in the rear. Using 4mm and 10mm sockets, remove the factory throttle cable bracket studs.

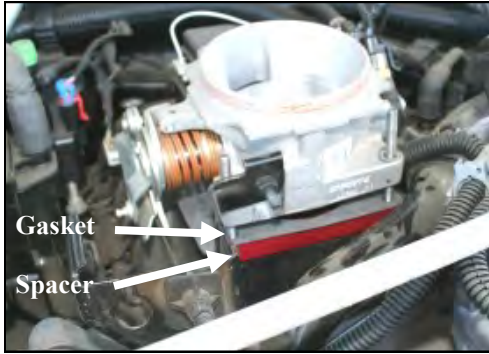

5. Place the fiber gasket between the Airaid spacer and the throttle body. Make sure the flat face of the Airaid spacer is against the throttle body with the bore extending into the intake manifold. **Use caution to retain the factory o-ring gasket on the intake manifold.**



6. Install one 1/2" round spacer under each hole in the throttle cable bracket. Install the 6mmx 30mm bolt in the front hole, and the 6mmx 35mm bolt in the rear hole. Re-install the throttle cable bracket and nut onto the front of the throttle body. Install one 6 mm washer and 6mm nut onto each of the three throttle body studs. Tighten all bolts and nuts securely. Reconnect the harness plugs on the throttle body.

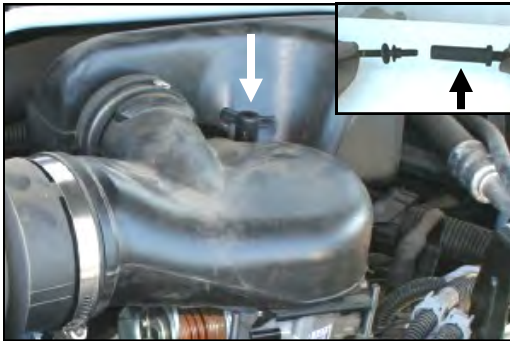

7. Using 6mm and 8mm wrenches, separate the factory rear throttle body stud as shown (reuse the top). Install the top of the stud onto the rear throttle body stud. Re-install the intake hat hold down nut. Tighten all bolts securely.



8. Re-install the intake tube, and tighten the hose clamps. Re-connect the breather hose elbow to the intake hat. **Re-connect the negative battery cable!**

The sound of power...The "whistle" means its working!

Contact your nearest Airaid dealer for an Airaid Intake System for your car, truck or SUV.

AIR-I20615C
Rev. 10.27.20