

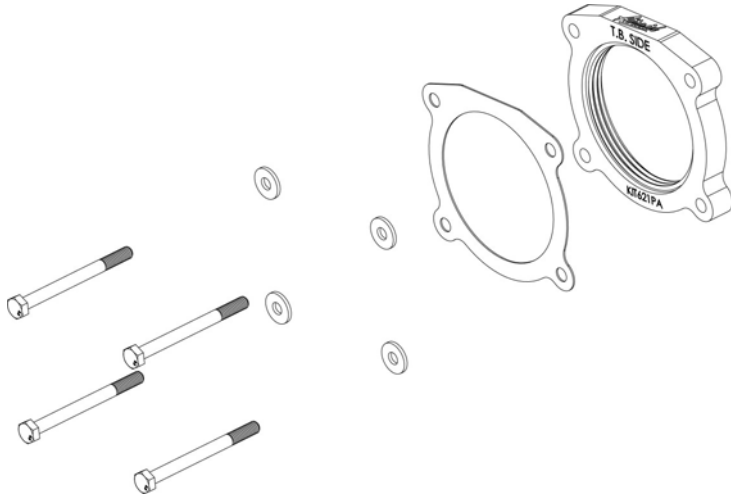

**Installation Instructions**  
**Part Number 510-621**  
**AIRAID Spacer For**  
**2007-14 Toyota Tundra**  
**2008-14 Toyota Sequoia**  
**5.7L V-8**  
**2010-14 Toyota Tundra**  
**2010-12 Toyota Sequoia**  
**4.6L V-8**



### Parts List

- |              |                      |     |
|--------------|----------------------|-----|
| AIR-KIT621PA | Aluminum Plate       | (1) |
| AIR-KIT621G  | Gasket               | (1) |
| AIR-KIT621H  | Hardware             |     |
| #3           | 6mm x 65mm Hex Bolts | (4) |
| #4           | 6mm Flat Washers     | (4) |

### Tools Required For Installation

- Flat Blade Screwdriver
- 10mm Socket
- Ratchet & Extension
- Pliers

**THROTTLE BODY SPACERS FOR VEHICLES LISTED ARE 50 STATE LEGAL. SEE AIRAID.COM FOR CARB STATUS ON EACH PART FOR A SPECIFIC VEHICLE.**

Thank you for purchasing the Airaid Throttle Body Spacer. Please read the instruction manual carefully before proceeding with the installation. Your Airaid Throttle Body Spacer was carefully inspected and packaged. Check that no parts are missing, or were damaged during shipping. If you need any assistance please call 1-800-858-3333 to speak with a representative in our Customer Service Center before returning the product.  
*Thank you for selecting AIRAID.*



**1. Disconnect the negative battery cable!**  
Remove the engine beauty cover by lifting up on the front, and then pulling it towards the front of the vehicle. (Save for reuse).

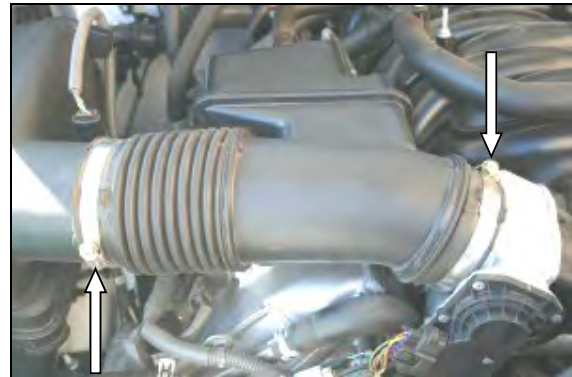

**2.** Using a 10mm socket, loosen two hose clamps on the factory intake tube. Slide the factory intake tube off of the throttle body and airbox. Move the factory intake tube aside, while leaving the factory vacuum and breather lines connected .

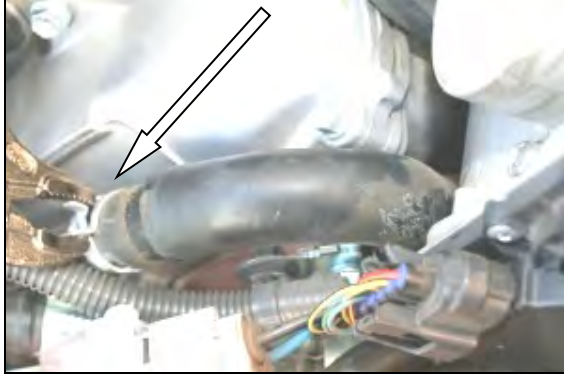

3. Using pliers, squeeze the tabs on the coolant hose clamp together. Slide the hose and clamp towards the passenger side approximately one half inch.

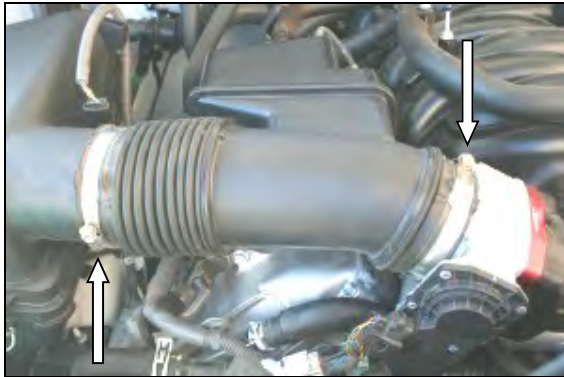

5. Re-install the factory intake tube and tighten the hose clamps securely.

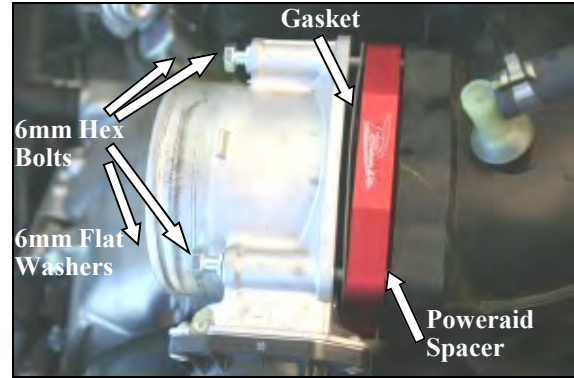

4. Using a 10mm socket, remove the four factory bolts on the throttle body. Gently move the throttle body towards the passenger side of the vehicle. Slide the Airaid Spacer (#1) and gasket (#2) between the throttle body and intake manifold. Insert four 6mm x 65mm hex bolts (#3), and 6mm flat washers (#4) thru the throttle body, gasket, Airaid Spacer, and into the intake manifold. Using a 10mm socket, tighten all four throttle body bolts evenly, to the manufacturers specifications. **Do Not Over Tighten The Bolts!**

6. Re-install the engine beauty cover.  
**Reconnect the negative battery cable!**

***The sound of power...The "whistle" means its working!***

Contact your nearest Airaid dealer for an Airaid Intake System for your car, truck or SUV.

AIR-I51621C  
Rev.07.31.20