

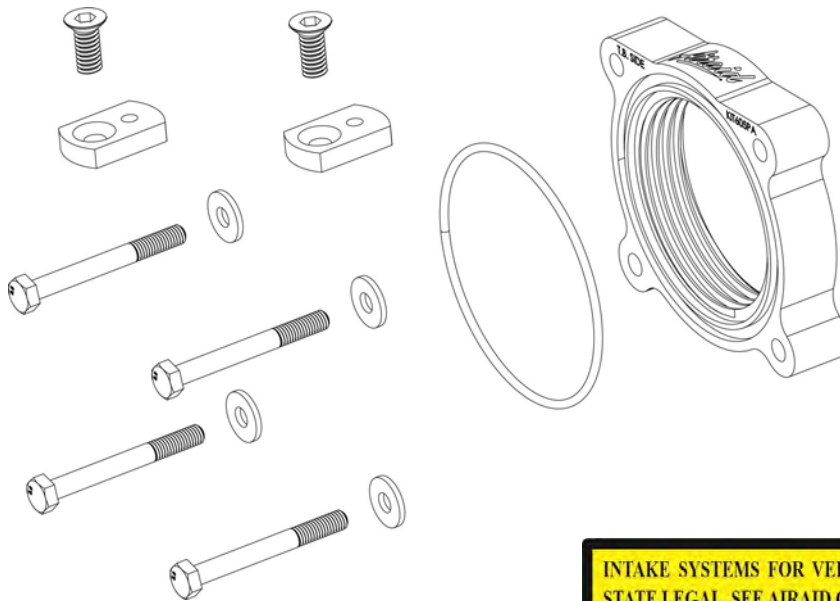

520-605 INSTALLATION INSTRUCTIONS
05-15 Nissan Frontier/Xterra
05-12 Nissan Pathfinder
2009-12 Suzuki Equator
4.0L V6

Thank you for purchasing the Airaid Throttle Body Spacer. Please read the instruction manual carefully before proceeding with the installation. Your Airaid Throttle Body Spacer was carefully inspected and packaged. Check that no parts are missing, or were damaged during shipping. If you need any assistance please call 1-800-858-3333 to speak with a representative in our Customer Service Center before returning the product.

Thank you for selecting AIRAID.



INTAKE SYSTEMS FOR VEHICLES LISTED ARE 50 STATE LEGAL. SEE AIRAID.COM FOR CARB STATUS ON EACH PART FOR A SPECIFIC VEHICLE.

Parts List		
AIR-KIT605PA	Aluminum Plate	(1)
AIR-KIT605H	Hardware	(1)
	O-Ring	(1)
	6mm x 70mm Hex Bolts	(4)
	6mm Flat Washers	(4)
	Extension Plates	(2)
	6mm x 16mm Flathead Screws	(2)

Also available for your 2005-10 Nissan Frontier, and 2009-10 Suzuki Equator, the AIRAID Intake System p/n 520-188. Please call for details!

Tools List
5/32" Allen Wrench
8mm Socket
Standard Screwdriver

Installation Instructions. Read Me!

1. **DISCONNECT NEGATIVE (-) BATTERY CABLE.**
2. Remove throttle body air intake system.
3. Remove (4) bolts from the throttle body. **(Ref. "A")**
4. Install power plate using (4) 6mm bolts and (4) 6mm washers. **(Ref. "B")**
* **Note: Install the 'O'-ring in the power plate and face towards the throttle body.**
5. Install (2) extension plates. **(Ref. "C")**
6. Inspect & Test the throttle linkage for full open & closed travel before driving. Some cruise or kickdown cables may require adjustment. Please refer to your vehicles service manual for proper adjusting.
7. Reinstall air intake system using **(Step 2)** as an example.
8. Reinstall negative battery cable. Enjoy!

The sound of power...The "whistle" means its working!

Ref. "A"- (1) Power Plate
(1) O-ring

Ref. "B"- (4) 6mm x 70mm Hex Bolts
(4) 6mm Flat Washers

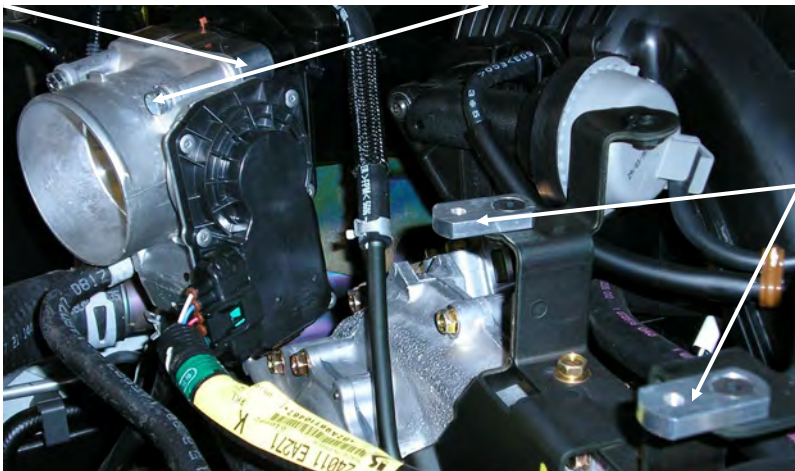

Ref. "C"- (2) Extension Plates
(2) 6mm x 16mm Screws

AIR-I52605D
Rev.06.16.20